

# DESH KA PUMP. SHAKTI PUMP.



**SUBMERSIBLE MOTORS**

**8 INCH MTSF**  
PRODUCT INFORMATION & SERVICE MANUAL



Dec./2014-15/L1/500 SAP No. 2900000286

India : Toll Free No. 1800 103 5555 Other Countries : +91-7292 410500

## SHAKTI PUMPS (I) LTD.

Sector - 3, Pithampur - 454774, Dist.- Dhar (M.P.) - INDIA  
 Fax: +91-7292-407044, E-mail : info@shaktipumps.com, sales@shaktipumps.com,  
 Visit us at : www.shaktipumps.com

## CONTENT

### 8" PRODUCT INFORMATION

Sectional View	02
Product Application And Product Specification	03
Model No. SS AISI 304/316 - 50/60 Hz	04
Motor Performance Data 50 Hz Data	05
Motor Performance Data 60 Hz Data	06
Motor Leads	07
Accessories & Checking And Filling	08
De-Rating Performance Curve	09

### SPARE PARTS

Exploded View With Spare Part 316	10
Sectional View	11
Description Of Parts	12-13
Replacement Rotors Assly & Replacement Sleeve	14-15
Standard Winding	16
Outline Drawing With Spare Parts	17

Considering continuous product development the information/performance/specifications and illustrations disseminated in this catalogue are subject to change without notice.

141101005

SUBMERSIBLE MOTORS			
Material	GG, Stainless Steel 304 / 316	Rating	30kW-93kW/40HP-125HP
Type	Rewindable	Thrust Rating	45.000 N

### 8" Rewindable

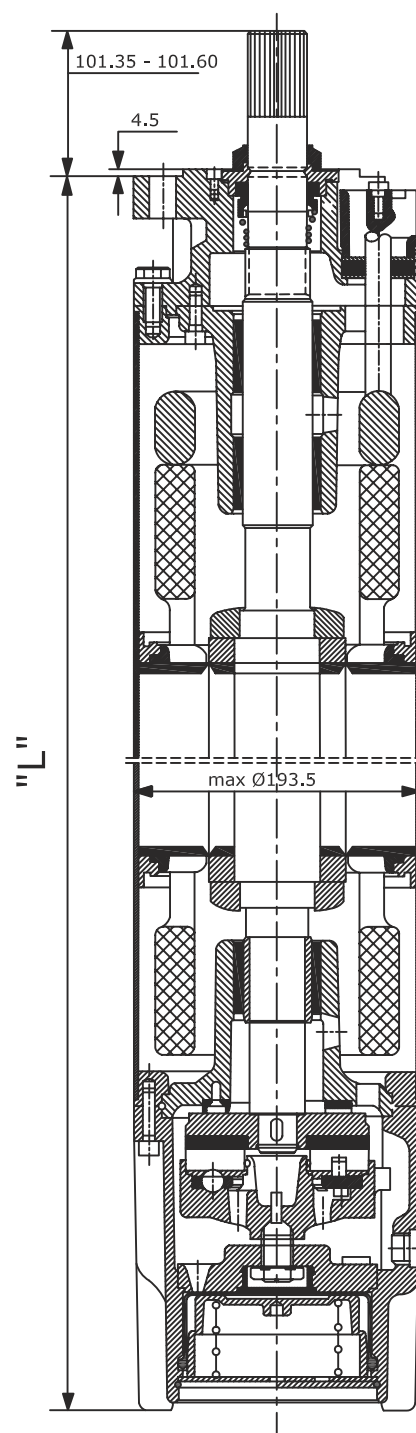

SUBMERSIBLE MOTORS			
Material	GG, Stainless Steel 304 / 316	Rating	30kW-93kW/40HP-125HP
Type	Rewindable	Thrust Rating	45.000 N

### 8" Rewindable Motor Product Information

Part	Material	
	304 (Standard)	316
Stator shell	SS AISI 304	SS AISI 316
End bell	Cast Iron / Power Coated	SS AISI 316
Thrust Housing	Cast Iron / Power Coated	SS AISI 316
Seals	BUNA-N	BUNA-N
Seal Cover	Cast Iron	SS AISI 316
Shaft Seal	SiC	SiC
Shaft end	SS AISI 304	SS AISI 316
Diaphragm	EPDM	EPDM
Diaphragm Cover	SS AISI 304	SS AISI 316
Lead	EPR	EPR

8" Rewindable motors are built for dependable operation in 8" diameter or larger water wells. Water lubricated thrust and radial bearings enable a maintenance free operation. The motors are ready to operate, providing frost protection down to -15 °C. Pressure relief valve as well as a special diaphragm ensure pressure compensation inside the motor.

#### Other Product advantages:

- Easy to mount with double flange
- Cable material according to drinking water regulations.
- SiC shaft seal for maximum sand protection
- High efficiency electrical design for low operation cost
- All motors pre filled and 100% tested
- Optional PT 100 sensor

#### Technical Specification Standard Motor

- 8" NEMA flange
- Protection: IP 68
- Starts per hour: max. 10
- Installation position: vertical/horizontal For horizontal operation you will need additional equipment, please contact Shakti Pumps 93 kW motors may not be installed horizontally
- Motor Lead in 6m length
- Voltage tolerance: +6%/-10%  
(Standard: 415 + 6% = 440V, 380 - 10% = 342V)
- Motor protection: Select thermal overloads according to VDE, trip class 10 or 10A, trip time < 10 s. at 5 x IN
- Standard motor with PVC winding insulation for max. ambient temperature of 30°C with a min. cooling flow:  
30 kW - 52 kW / 40 HP-70 HP v = 0.2 m/s  
55 kW - 93 kW / 75 HP-125 HP v = 0.5 m/s

#### Optional

- Motors in complete SS AISI 316
- PE2/PA winding insulation for max ambient temp. of 50°C at the same cooling conditions as standard
- PT 100 temperature sensor (sold separately)
- Drop cable in different length up to 50m

SUBMERSIBLE MOTORS			
Material	GG, Stainless Steel 304 / 316	Rating	30kW-93kW/40HP-125HP
Type	Rewindable	Thrust Rating	45.000 N

**8" Rewindable Motors - Model Numbers 50/60 Hz**

[HP]	[kw]	[v] / [Hz]	Model Number	
			DOL	YΔ
40	30	380, 400, 415/50	9000006583	9000006593
		460/60	9000006583	9000006593
50	37	380, 400, 415/50	9000006584	9000006594
		460/60	9000006584	9000006594
60	45	380, 400, 415/50	9000006585	9000006595
		460/60	9000006585	9000006595
70	52	380, 400, 415/50	9000006586	9000006596
		460/60	9000006586	9000006596
75	55	380, 400, 415/50	9000006587	9000006597
		460/60	9000006587	9000006597
80	60	380, 400, 415/50	9000006588	9000006598
		460/60	9000006588	9000006598
85	67	380, 400, 415/50	9000006589	9000006599
		460/60	9000006589	9000006599
100	75	380, 400, 415/50	9000006590	9000006600
		460/60	9000006590	9000006600
110	83	380, 400, 415/50	9000006591	9000006601
		460/603	9000006591	9000006601
125	93	380, 400, 415/50	9000006592	9000006602
		460/60	9000006592	9000006602

SUBMERSIBLE MOTORS			
Material	GG, Stainless Steel 304 / 316	Rating	30kW-93kW/40HP-125HP
Type	Rewindable	Thrust Rating	45.000 N

**8" Rewindable Motors Performance Data 50 Hz**

[HP]	P <sub>N</sub> [kW]	Thrust F [N]	U <sub>N</sub> [V]	n <sub>N</sub> [min-1]	I <sub>N</sub> [A]	I <sub>A</sub> [A]	η(Eff.)[%] at % load			COS φ ( PF) at % load			T <sub>N</sub> [Nm]	T <sub>A</sub> [Nm]
							50	75	100	50	75	100		
40	30	45000	380	2880	63	300	83.5	84.4	83.1	0.89	0.88	0.89	99	126
			400	2900	60	318	83.6	85	84.3	0.8	0.86	0.89	99	141
			415	2910	58	332	83.5	85.2	84.9	0.77	0.89	0.88	98	151
50	37	45000	380	2890	79	378	84.6	85.3	83.9	0.8	0.86	0.88	122	156
			400	2900	76	400	83.9	85.2	84.6	0.74	0.82	0.86	122	176
			415	2910	75	412	82.6	84.5	84.3	0.7	0.8	0.84	121	190
60	45	45000	380	2900	93	491	85.8	86.4	85.2	0.79	0.86	0.88	149	218
			400	2910	90	520	85.3	86.5	85.9	0.74	0.82	0.86	148	241
			415	2910	89	541	84.5	86.2	85.8	0.69	0.79	0.84	148	263
70	52	45000	380	2900	107	575	86.5	86.7	85.3	0.81	0.87	0.89	175	284
			400	2910	103	608	86.4	87.1	86.2	0.76	0.84	0.87	175	318
			415	2920	101	633	85.6	87	86.7	0.71	0.8	0.85	174	345
75	55	45000	380	2900	114	624	86.5	86.9	85.7	0.78	0.85	0.88	182	301
			400	2915	110	660	85.9	87	86.4	0.72	0.82	0.86	181	340
			415	2920	109	688	84.8	86.4	86.2	0.67	0.78	0.84	181	366
80	60	45000	380	2900	122	698	87.2	87.6	86.5	0.81	0.87	0.89	198	319
			400	2910	116	725	86.8	87.7	87	0.77	0.84	0.88	197	357
			415	2920	115	768	86.1	87.4	87.1	0.73	0.82	0.86	197	387
90	67	45000	380	2900	137	759	87.2	87.6	86.4	0.79	0.86	0.89	220	352
			400	2910	113	797	86.5	87.5	86.9	0.874	0.82	0.86	220	395
			415	2920	131	828	85.6	87	86.6	0.69	0.79	0.84	219	427
100	75	45000	380	2900	154	892	86.7	87.1	85.9	0.79	0.86	0.89	247	419
			400	2910	148	942	86.2	87.3	86.7	0.74	0.83	0.87	246	472
			415	2920	147	982	85.4	86.9	86.6	0.69	0.79	0.84	245	510
110	83	45000	380	2910	166	1019	87.8	88.3	87.2	0.81	0.87	0.89	275	483
			400	2920	160	1077	87.5	88.4	87.6	0.77	0.84	0.88	273	544
			415	2925	156	1120	87.2	88.4	88	0.73	0.82	0.86	273	586
125	93	45000	380	2910	188	1186	87.8	88.4	87.5	0.77	0.85	0.88	306	557
			400	2920	183	1276	87.2	88.3	87.8	0.71	0.81	0.86	305	626
			415	2930	184	1308	86.2	87.8	87.7	0.65	0.76	0.83	305	676

SUBMERSIBLE MOTORS			
Material	GG, Stainless Steel 304 / 316	Rating	30kW-93kW/40HP-125HP
Type	Rewindable	Thrust Rating	45.000 N

### 8" Rewindable Motors Performance Data 60 Hz

[HP]	P <sub>N</sub> [kW]	Thrust F [N]	U <sub>N</sub> [V]	n <sub>N</sub> [min-1]	I <sub>N</sub> [A]	I <sub>A</sub> [A]	η(Eff.)[%] at % load			COS Φ (PF) at % load			T <sub>N</sub> [Nm]	T <sub>A</sub> [Nm]
							50	75	100	50	75	100		
40	30	45000	460	3490	61	324	81.5	83.6	83.5	0.82	0.87	0.89	99	130
50	37	45000	460	3490	75	407	83.8	85.3	84.8	0.77	0.84	0.87	123	162
60	45	45000	460	3500	89	524	85	86.6	86.3	0.77	0.84	0.87	149	221
70	52	45000	460	3510	102	606	85	86.6	86.2	0.79	0.86	0.88	175	276
75	55	45000	460	3510	109	657	85.8	87.1	86.7	0.77	0.84	0.87	181	287
80	60	45000	460	3510	116	734	85.4	86.9	86.7	0.8	0.86	0.89	198	332
90	67	45000	460	3510	131	803	85.7	87.2	86.9	0.77	0.85	0.87	220	366
100	75	45000	460	3510	145	947	86.3	87.8	87.4	0.77	0.85	0.88	247	427
110	83	45000	460	3510	158	1090	86.5	87.9	87.7	0.8	0.86	0.89	275	489
125	93	45000	460	3510	180	1256	86.7	88.3	88.3	0.76	0.83	0.87	306	561

### Motor Lengths & Weights

P [HP]	P [kW]	L [mm]	Packing Size [mm]	Motor Weights [kg]	
				304/316 904L	Incl. Packing [kg]
40	30	1140	1550X200X290	146	164
50	37	1140	1550X200X290	146	164
60	45	1230	1550X200X290	168	189
70	52	1340	1650X200X290	181	203
75	55	1340	1650X200X290	181	203
80	60	1470	1850X200X290	228	245
85	67	1470	1850X200X290	228	245
100	75	1560	2000X200X290	228	245
110	83	1740	2100X200X290	260	292
125	93	1740	2100X200X290	260	292

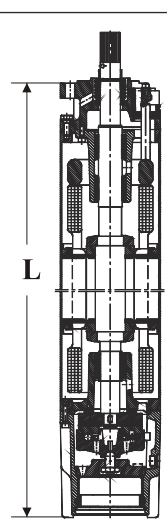

SUBMERSIBLE MOTORS			
Material	GG, Stainless Steel 304 / 316	Rating	30kW-93kW/40HP-125HP
Type	Rewindable	Thrust Rating	45.000 N

### 8" Rewindable Motors Leads @ 400 V

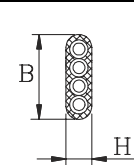
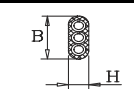
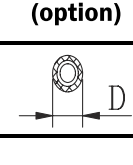
DOL	[HP]	[kW]	Ø [mm2]	B/H [mm]		Length [M]	St.	Lead Mod. Nr.	Lead seal Kite Mod. Nr.
				B	H				
	40-60	30-45	1x4x10	B	30.0	6m	1	1000001250	-
				H	10.5				
	70-80	52-60	1x4x16	B	38.0	6m	1	1000001252	-
				H	12.8				
	85-125	67-93	1x3x25	B	37.5	6m	1	1000001421	-
				H	16.0				

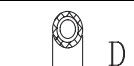
Ground Lead (option)	[HP]	[kW]	Ø [mm2]	Length [M]	D [mm]	St.	Mod. Nr.
	85-125	67-93	1x25	6m	13	1	308 053 080

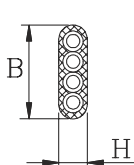
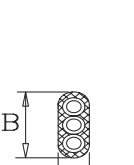
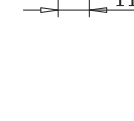
Y Δ Lead	[HP]	[kW]	Ø [mm2]	B/H [mm]		Length [M]	St.	Lead Mod. Nr.	Lead seal Kite Mod. Nr.	
				B	H					
	40-75	30-55	1x3x6	B	19.5	6m	1	1000001261	-	
				H	9.5					
				1x4x6	B			25.0		1000001262
					H			9.0		
	80-100	60-75	1x3x10	B	24.5	6m	1	1000001249	-	
				H	11.5					
				1x4x10	B			30.0		1000001250
					H			10.5		
	110-125	83-93	1x3x16	B	28.8	6m	1	1000001251	-	
				H	12.2					
				1x4x16	B			38.0		1000001252
					H			12.8		

SUBMERSIBLE MOTORS			
Material	GG, Stainless Steel 304 / 316	Rating	30kW-93kW/40HP-125HP
Type	Rewindable	Thrust Rating	45.000 N

### Accessories

#### PT 100

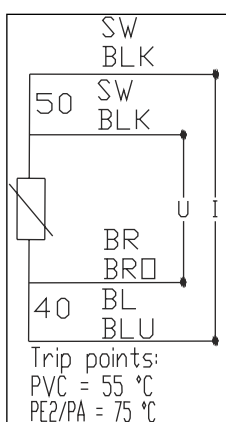
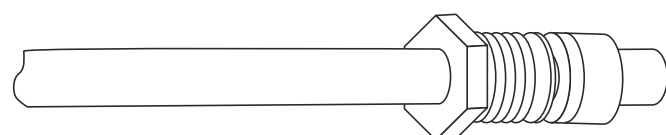

PT 100	10 m	Mod.- No. :	PT 100 010
PT 100	20 m	Mod.- No. :	PT 100 020
PT 100	30 m	Mod.- No. :	PT 100 030
PT 100	50 m	Mod.- No. :	PT 100 050

### Motorfluid Checking and Refilling

Filling Kit	Mod.- No.:	MTSFC200
Filling liquid SL / Glycol	Mod.- No.:	03520009

SUBMERSIBLE MOTORS			
Material	GG, Stainless Steel 304 / 316	Rating	30kW-93kW/40HP-125HP
Type	Rewindable	Thrust Rating	45.000 N

### 8" Rewindable Motors Performance Data 50Hz

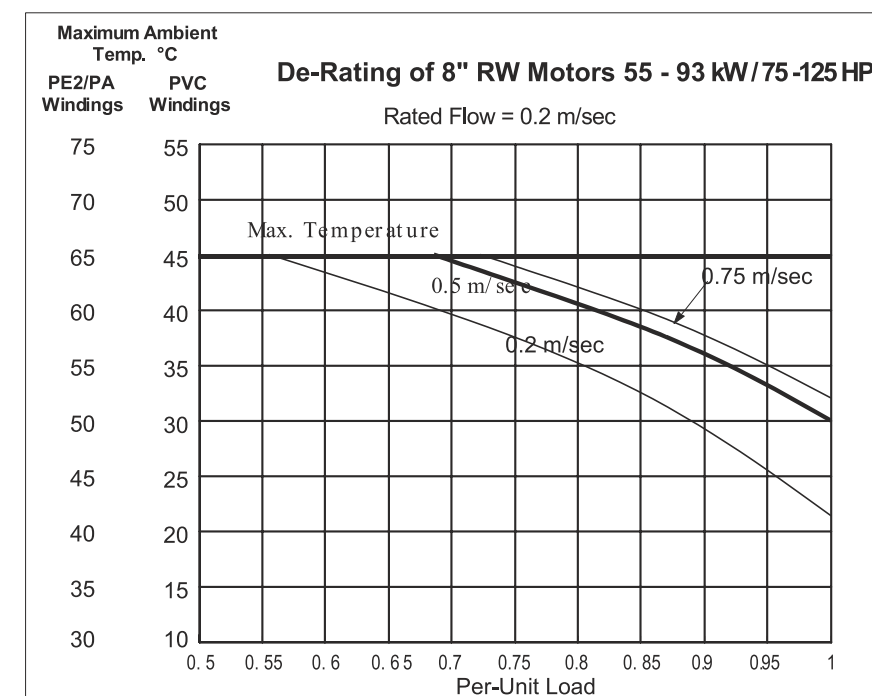
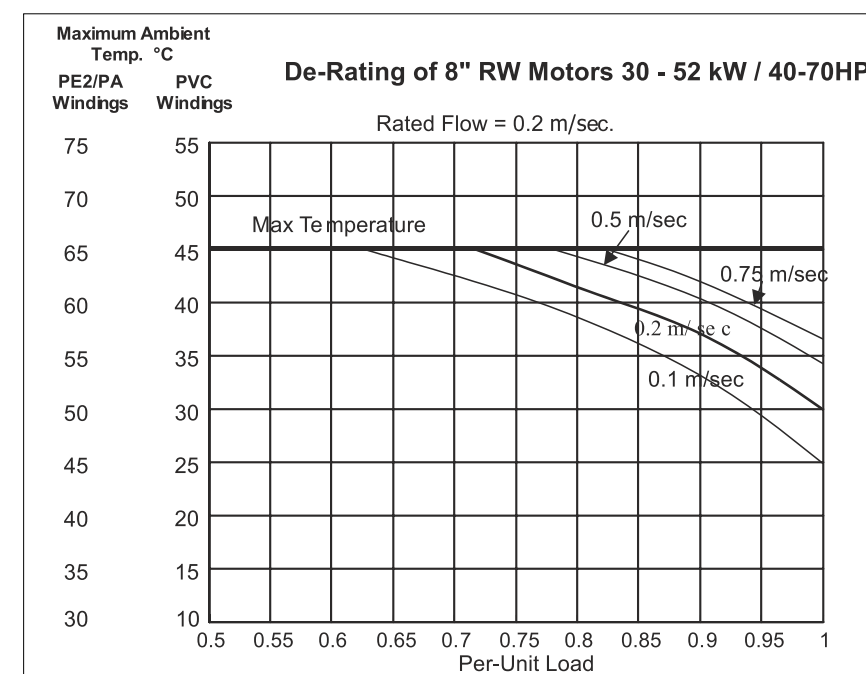

SUBMERSIBLE MOTORS			
Material	GG, Stainless Steel 304 / 316	Rating	30kW-93kW/40HP-125HP
Type	Rewindable	Thrust Rating	45.000 N

### Exploded View

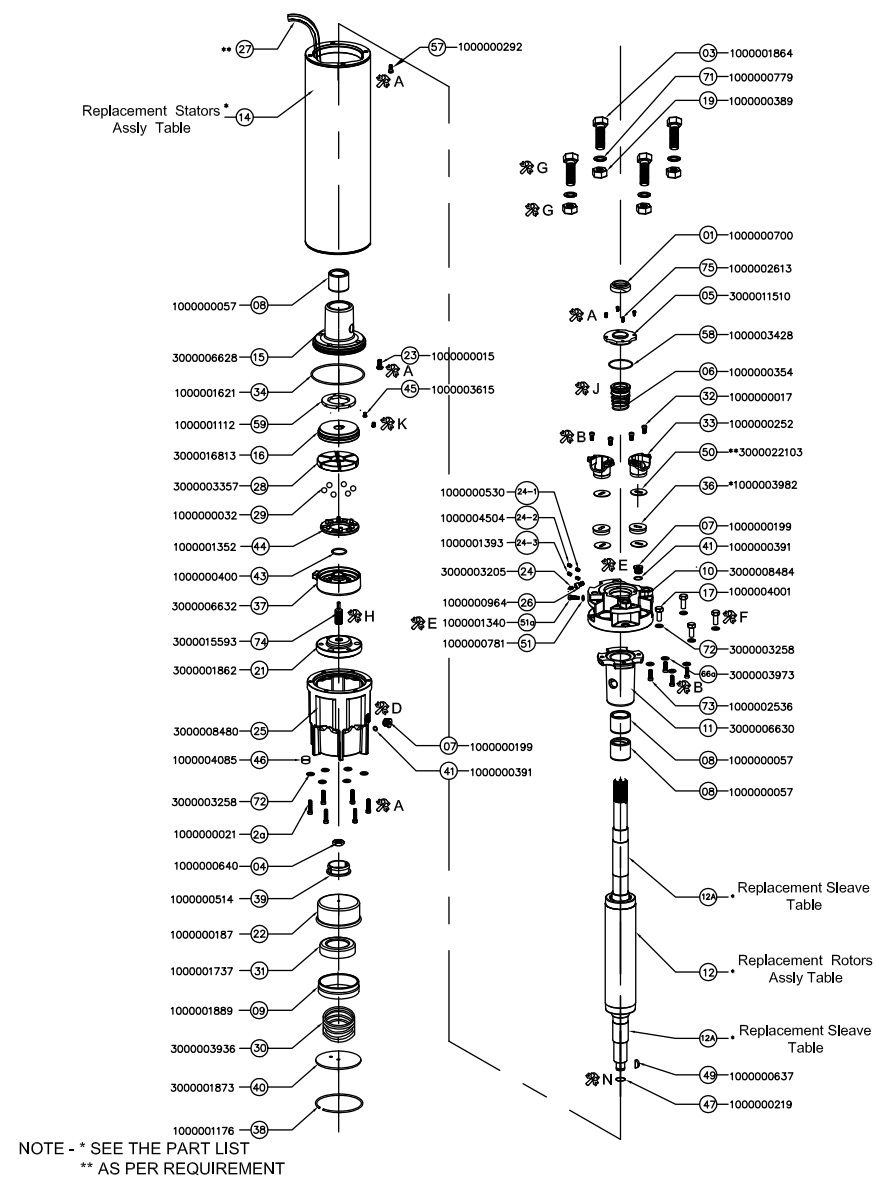

TOOLS						
A	B	C	D	E	F	G
ALLEN KEY 4mm(M5)	ALLEN KEY 6mm(M8)	ALLEN KEY 8mm(M10)	ALLEN KEY 10mm(M12)	SPANER NO. 14(M8)	SPANER NO. 19(M12)	SPANER NO. 24(M16)
H	I	J	K	L	M	N
TOOL OF ADJUSTING STUD SAP CODE - 43-28906	TOOL OF AUXILIARY IMP. FITTING (TEFLON) SAP CODE - 43-28907	TOOL OF MECHANICAL SEAL FITTING (TEFLON) SAP CODE - 43-28905	SCREW DRIVER	HAMMER (TEFLON) SAP CODE - 43-2876	SCOKET SPANNER NO. 30(M24)	EXTERNAL CIRCLIP PLIER

SUBMERSIBLE MOTORS			
Material	GG, Stainless Steel 304 / 316	Rating	30kW-93kW/40HP-125HP
Type	Rewindable	Thrust Rating	45.000 N

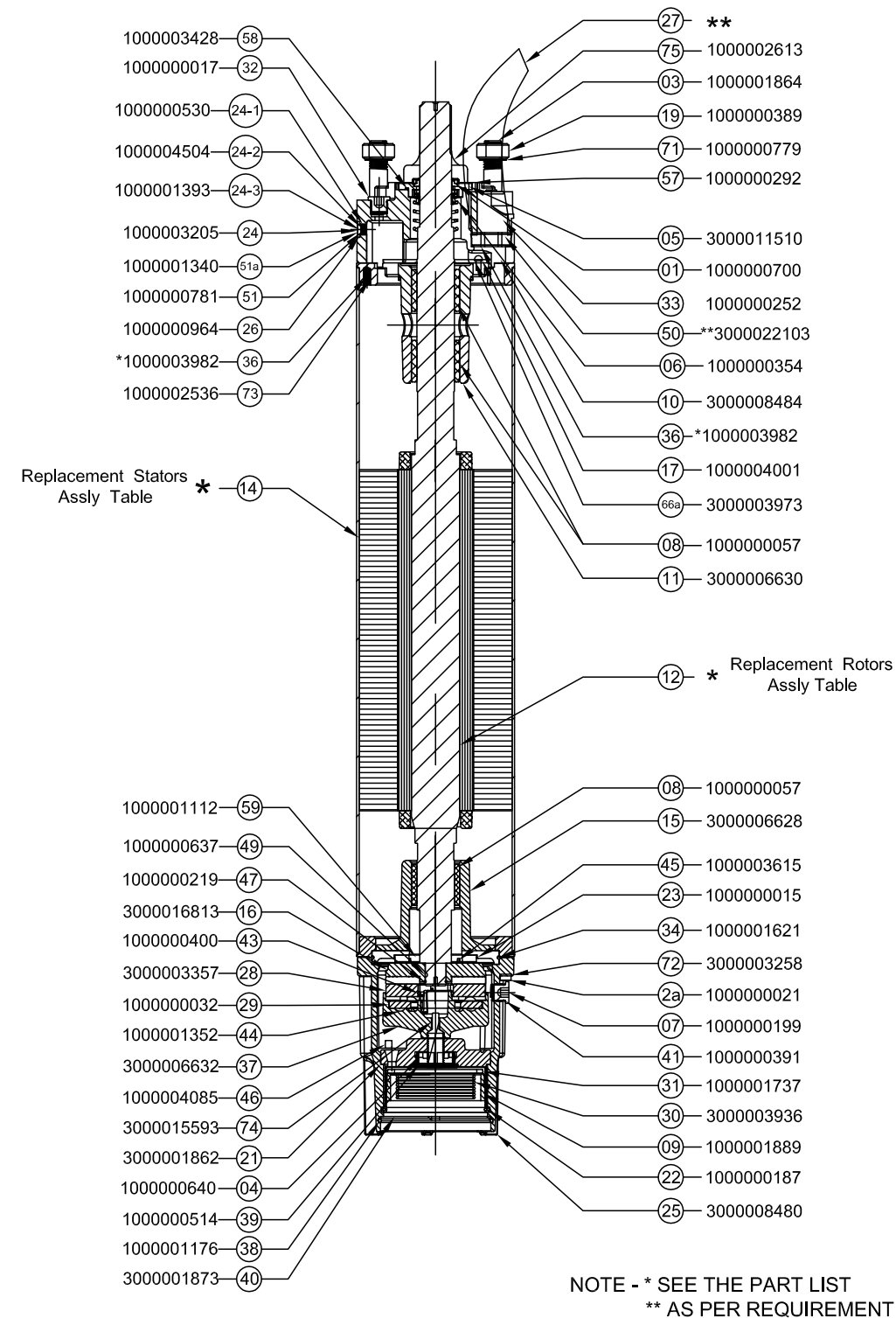

SUBMERSIBLE MOTORS			
Material	GG, Stainless Steel 304 / 316	Rating	30kW-93kW/40HP-125HP
Type	Rewindable	Thrust Rating	45.000 N

POS	MATERIAL CODE	PART DISCIPTION	QTY	MATERIAL
3	1000001864	HH BOLT M16XX60SS	4	SS AISI-304
71	1000000779	SPRING WASHER	4	SS AISI-304
19	1000000389	NUT(M16)	4	SS AISI-304
1	1000000700	SAND SLINGER	1	NBR
75	1000002613	ALLEN BOLT M5X10	4	SS AISI-304
5	3000011510	DUST COVER	1	CI FG-260
58	1000003428	O-RING(Ø64.5X2.5)	1	NBR
6	1000000354	MECHANICAL SEAL	1	N/A
32	1000000017	ALLEN BOLT M8X16	4	SS AISI-304
33	1000000252	GLAND	2	PPS 30/PPO 20
50	3000022103	GROMMET COVER(18.5X40.5)	4	SS AISI-304
	3000001886	GROMMET COVER (12.6X34)		SS AISI-304
36	1000003981	GROMMET (6SQ. X 3 CORE)	2	NITRIL RUBBER
	1000003982	GROMMET (6SQ. X 4 CORE)		
	1000003983	GROMMET(10SQ. X 3 CORE)		
	1000003984	GROMMET(10SQ. X 4 CORE)		
	1000003985	GROMMET(16SQ. X 3 CORE)		
	1000003986	GROMMET(16SQ. X 4 CORE)		
	1000003987	GROMMET(25SQ. X 3 CORE)		
1000003988	GROMMET(25SQ. X 4 CORE)			
7	1000000199	DRAIN PLUG	1	BRASS
41	1000000391	O-RING 10X2.1MM	1	NBR
10	3000008484	ADOPTER UP.HSG	1	CI FG-260
17	1000004001	HH BOLT M12XX35SS	4	SS AISI-304
72	3000003258	SS WASHER	4	SS AISI-304
66a	3000003973	SS WASHER	4	EN 1.4509
73	1000002536	ALLEN BOLT M8X30	4	SS AISI-304
11	3000006630	BRG BODY UPPER	1	CI FG-260
8	1000000057	BUSH CARBON	2	METAL IMPREGNATED ANTI-MONY
12	*	ROTOR SUB ASSLY	1	N/A
49	1000000637	S.S. KEY	1	SS
47	1000000219	EXT.CIRCLIP	1	SS AISI-304
57	1000000292	HH BOLT M8XX12	1	SS AISI-304
23	1000000015	ALLEN BOLT M8X10	1	SS AISI-304
45	1000003615	COUNTER SHANK SCREW	2	SS AISI-304
24-1	1000000530	PVC CAP	1	PP
24-2	1000004504	PVC CAP	1	PP
24-3	1000001393	FILTER	2	N/A
24	3000003205	PRESSURE RELIEF VALVE ASSLY.	2	N/A
26	1000000964	THRD.PLUG VALUE	1	SS AISI-304
51a	1000001340	ALLEN BOLT M8X12	1	SS AISI-304
51	1000000781	SPRING WASHER	1	SS AISI-304

SUBMERSIBLE MOTORS			
Material	GG, Stainless Steel 304 / 316	Rating	30kW-93kW/40HP-125HP
Type	Rewindable	Thrust Rating	45.000 N

POS	MATERIAL CODE	PART DISCIPTION	QTY	MATERIAL
7	1000000199	DRAIN PLUG	1	BRASS
41	1000000391	O-RING	1	NBR
27	**	CABLE(AS PER ODER)	N/A	RUBBER
14	*3000018998	STATOR SUB ASSLY	1	N/A
8	1000000057	BUSH CARBON	1	METAL IMPREGNATED ANTI-MONY
15	3000006628	BRG BODY LOWER	1	CI FG-260
34	1000001621	O-RING	1	NBR
59	1000001112	UPTHRUST BEARING	1	CARBON
16	3000016813	REVOLVING PLATE ASSLY	1	N/A
28	3000003357	THRUST BER SEGMENT	6	SS AISI-420
29	1000000032	BALL 15	6	SS AISI-304
44	1000001352	THRUST BALL RETAINER	1	LTB-2
43	1000000400	O-RING	1	NBR
37	3000006632	BRG SEG .CARRIER	1	CI FG-260
74	3000015593	GRUB SCREW	1	SS AISI-304
21	3000001862	THRUST SUPPORT	1	CI FG-260
25	3000008480	MOTOR BASE	1	CI FG-260
46	1000004085	MAGNET	1	MAGNET
72	3000003258	SS WASHER	6	SS AISI-304
2a	1000000021	ALLEN BOLT M8X40	6	SS AISI-304
4	1000000640	SS LOCK NUT	1	SS AISI-420
39	1000000514	PROTECTION PLUG	1	PP/PLASTIC
22	1000000187	DIAPHRAM	1	EPDM
31	1000001737	SPRING BASE CUP	1	ABS
9	1000001889	SUPPORING RING	1	PP/PLASTIC
30	3000003936	SPRING DIAPHRAM	1	SS AISI-304
40	3000001873	COVER PLATE	1	SS AISI-304
38	1000001176	WIRE CIRCLIP	1	SS AISI-304



SUBMERSIBLE MOTORS			
Material	GG, Stainless Steel 304 / 316	Rating	30kW-93kW/40HP-125HP
Type	Rewindable	Thrust Rating	45.000 N

#### Replacement Rotors Assly

POS	P <sub>N</sub>	P <sub>N</sub>	ROTOR	ROTOR MODEL NO.
	[HP]	[kW]		
12.01	30.00	22.00	ROTOR ASSLY	3000017372
12.02	40.00	30.00	ROTOR ASSLY	3000002188
12.03	50.00	37.00	ROTOR ASSLY	3000002188
12.04	60.00	45.00	ROTOR ASSLY	3000002189
12.05	70.00	52.00	ROTOR ASSLY	3000002190
12.06	75.00	55.00	ROTOR ASSLY	3000002190
12.07	80.00	60.00	ROTOR ASSLY	3000002191
12.08	90.00	67.50	ROTOR ASSLY	3000002191
12.09	100.00	75.00	ROTOR ASSLY	3000002192
12.10	110.00	83.00	ROTOR ASSLY	3000002193
12.11	125.00	93.00	ROTOR ASSLY	3000002193

#### Replacement Sleeve

POS	P <sub>N</sub>	P <sub>N</sub>	UPPER SLEEVE	LOWER SLEEVE	ROTOR MODEL NO.
	[HP]	[kW]			
12A.01	30.00	22.00	LENGTH - 75.0mm 3000003928 (2 NOS USE)	LENGTH - 75.0mm 3000003928 (1 NOS USE)	3000017372
12A.02	40.00	30.00			3000002188
12A.03	50.00	37.00			3000002188
12A.04	60.00	45.00			3000002189
12A.05	70.00	52.00			3000002190
12A.06	75.00	55.00			3000002190
12A.07	80.00	60.00			3000002191
12A.08	90.00	67.50			3000002191
12A.09	100.00	75.00			3000002192
12A.10	110.00	83.00			3000002193
12A.11	125.00	93.00			3000002193

SUBMERSIBLE MOTORS			
Material	GG, Stainless Steel 304 / 316	Rating	30kW-93kW/40HP-125HP
Type	Rewindable	Thrust Rating	45.000 N

#### Replacement Stators Assly

POS	P <sub>N</sub>	P <sub>N</sub>	STATOR	ROTOR MODEL NO.
	[HP]	[kW]		
14.01	30.00	22.00	STATOR ASSLY	3000017371
14.02	40.00	30.00	STATOR ASSLY	3000002233
14.03	50.00	37.00	STATOR ASSLY	3000002233
14.04	60.00	45.00	STATOR ASSLY	3000002234
14.05	70.00	52.00	STATOR ASSLY	3000002235
14.06	75.00	55.00	STATOR ASSLY	3000002235
14.07	80.00	60.00	STATOR ASSLY	3000002236
14.08	90.00	67.50	STATOR ASSLY	3000002236
14.09	100.00	75.00	STATOR ASSLY	3000002237
14.10	110.00	83.00	STATOR ASSLY	3000002238
14.11	125.00	93.00	STATOR ASSLY	3000002238

SUBMERSIBLE MOTORS			
Material	GG, Stainless Steel 304 / 316	Rating	30kW-93kW/40HP-125HP
Type	Rewindable	Thrust Rating	45.000 N

[kW]	[HP]	[V]/Hz	Stator incl. Winding		ROTOR
			DOL	YΔ	
30	40	380, 400, 415/50, 460/60	300003160	300003161	300002188
37	50	380, 400, 415/50, 460/60	300003811	300008280	300002188
45	60	380, 400, 415/50, 460/60	300003812	300003813	300002189
52	70	380, 400, 415/50, 460/60	300008283	300008284	300002190
55	75	380, 400, 415/50, 460/60	300003814	300003815	300002190
60	80	380, 400, 415/50, 460/60	300008281	300008282	300002191
67	85	380, 400, 415/50, 460/60	300008279	300004057	300002191
75	100	380, 400, 415/50, 460/60	300003816	300003817	300002192
83	110	380, 400, 415/50, 460/60	300004054	300004055	300002193
93	125	380, 400, 415/50, 460/60	300003162	300003818	300002193

**Standard Windings (380 – 415 / 460 Volt and 50 / 60 Hz)**

[HP]	[kW]	Mod.-No. Winding kits	Turns per coil	Wire diameter No. of wire	Type of Isolation	Group connection	Total Wire length [m]	Resistant coil [Ω]	Resistant YΔ (U1-U2) [Ω]	Resistant Dol (U1-V1) [Ω]
40	30	326 349 999	9+10+9+10	3.1 x 1	PVC	Series	450.00	0.41	0.8200	0.30
50	37	326 101 999	17+17+17+17	2.4 x 1	PVC	Parallel	630.00	0.45	0.9000	0.38
60	45	326 110 999	14+14+14+14	2.6 x 1	PVC	Parallel	582.48	0.30	0.1500	0.25
70	52	326 120 999	12+12+12+12	2.8 x 1	PVC	Parallel	655.00	0.32	0.1700	0.21
75	55	326 119 999	11+12+11+12	2.0 x 2	PVC	Parallel	542.40	0.29	0.1540	0.19
80	60	326 129 999	10+10+10+10	2.2 x 2	PVC	Parallel	536.40	0.24	0.1280	0.20
85	67	326 128 999	9+10+9+10	2.2 x 2	PVC	Parallel	510.48	0.19	0.1100	0.14
100	75	326 135 999	8+9+8+9	2.4 x 2	PVC	Parallel	990.72	0.18	0.0957	0.14
110	83	326 142 999	7+8+7+8	2.5 x 2	PVC	Parallel	1008.00	0.16	0.0851	0.11
125	93	326 141 999	7+7+7+7	2.6 x 2	PVC	Parallel	943.20	0.70	0.0851	0.11

**Spare parts : Other**

Pictured Repair instruction	Mod.- No.:	MTSFC200
Filling liquid 20 l / -15°C	Mod.- No.:	03520009

**Insulation Resistance (20°C/500 VDC)**

New motor without drop cable	200 > MΩ
Used motor without drop cable	20 > MΩ
New motor with drop cable	2 > MΩ
Used motor with drop cable	0.5 -2 MΩ

SUBMERSIBLE MOTORS			
Material	GG, Stainless Steel 304 / 316	Rating	30kW-93kW/40HP-125HP
Type	Rewindable	Thrust Rating	45.000 N

**Outline drawings**

