

# DESH KA PUMP. SHAKTI PUMP.



**SUBMERSIBLE MOTORS**

**6 INCH MTSF**  
PRODUCT INFORMATION & SERVICE MANUAL



Dec./2014-15/L1/500 SAP No. 2900000121

India : Toll Free No. 1800 103 5555 Other Countries : +91-7292 410500

## SHAKTI PUMPS (I) LTD.

Sector - 3, Pithampur - 454774, Dist.- Dhar (M.P.) - INDIA  
 Fax: +91-7292-407044, E-mail : info@shaktipumps.com, sales@shaktipumps.com,  
 Visit us at : www.shaktipumps.com

## CONTENT

### 6" PRODUCT INFORMATION

Sectional View	02
Product Application And Product Specification	03
Model No. SS AISI 304/316 - 50/60 Hz	04-07
Motor Performance Data 50 Hz	08
Motor Performance Data 60 Hz	09
Motor Length & Weight 304/316 Leads	09-10
De-Rating Performance Curve	11

### SPARE PARTS

Exploded View With Spare Part List	12
Sectional View	13
Description Of Parts	14-15
Model Number - Rotor, Sleeve, Stator	16-17
Standard Winding	18
Outline Drawing With Spare Parts	19

Considering continuous product development the information/performance/specifications and illustrations disseminated in this catalogue are subject to change without notice.

01011023

SUBMERSIBLE MOTORS			
Material	GG, Stainless Steel 304/316	Rating	3.7kW-37kW/5HP-50HP
Type	Rewindable MTSFC/ MTSFN	Thrust Rating	15500-27500

### 6" Rewindable

304

316

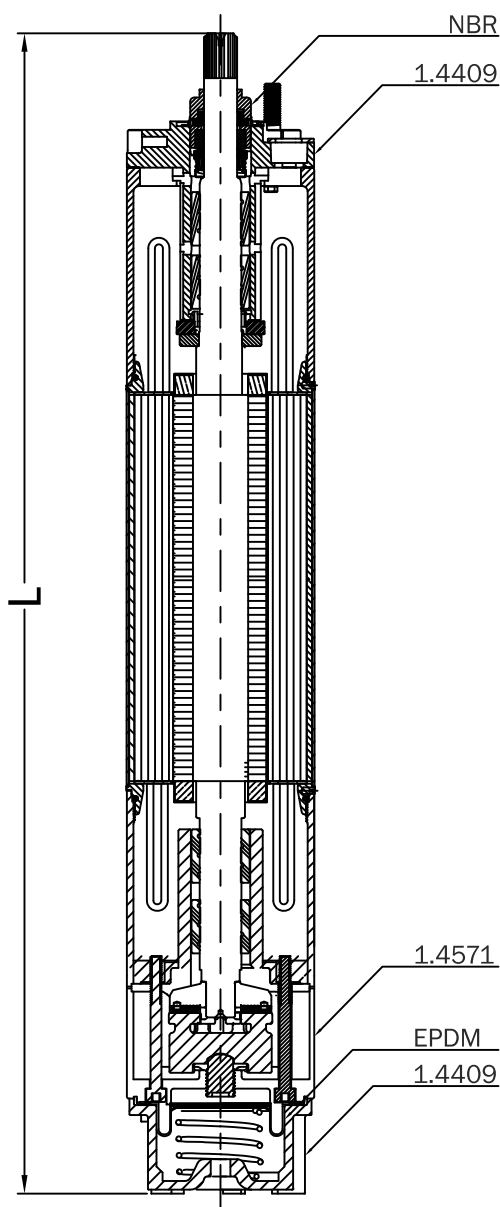
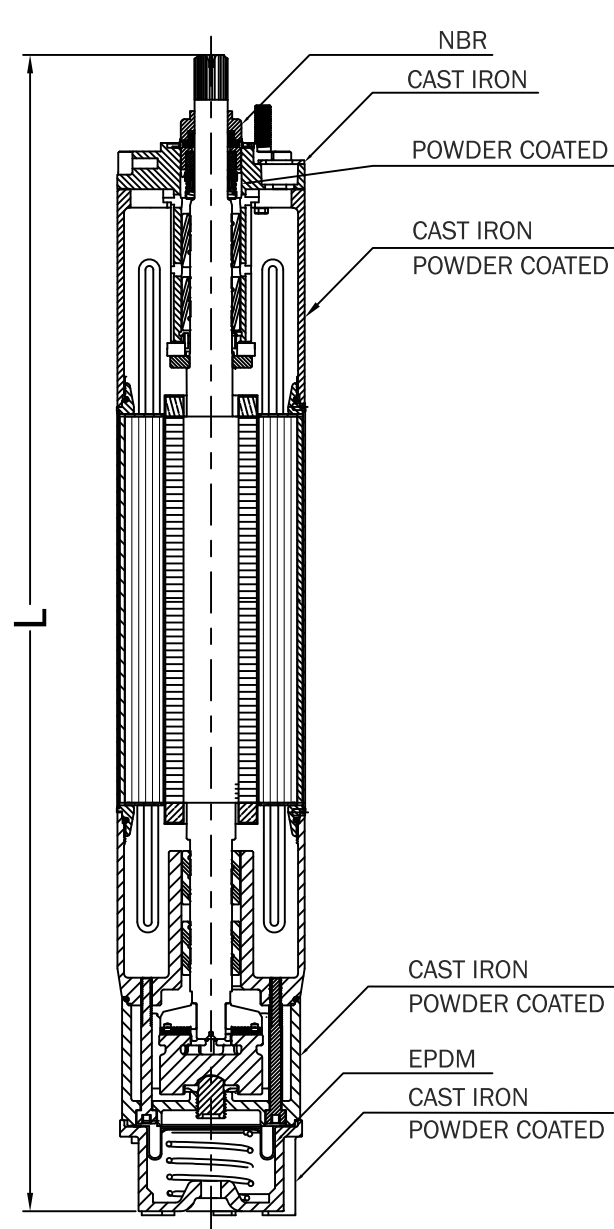

SUBMERSIBLE MOTORS			
Material	GG, Stainless Steel 304/316	Rating	3.7kW-37kW/5HP-50HP
Type	Rewindable MTSFC/ MTSFN	Thrust Rating	15500-27500

### 6" Rewindable Motor Product Information

#### Application

6" Rewindable motors are built for dependable operation in 6" diameter or larger water wells. Water lubricated thrust and radial bearings enable a maintenance free operation. The motors are ready to operate, providing frost protection down to -15°C.

Fill and check valve, as well as a preloaded special diaphragm, ensure pressure compensation inside the motor. (inside pressure 0.5 - 0.7 bar)

#### Other Product advantages:

- Cable material according to drinking water regulations
- Sand slinger and shaft seal for high performance in sand
- High efficiency electrical design for low operation cost
- All motors prefilled and 100% tested
- Design for retrofitable PT100 sensor

#### Technical Specifications

##### Standard Motor

- 150 MM NEMA – flange with Studs (M 12)
- Protection: IP 68
- Starts per hour: max. 20
- Installation position: vertical / horizontal
- Motor Lead in 4m length
- Voltage tolerance: +6% / -10%  
(Standard: 415 + 6% = 440V, 380 – 10% = 342V)
- Motor protection : Select Thermal overload
- Standard motor with Taping winding insulation for max. ambient of 30°C with a min.  
Cooling flow: 4 kW - 15 kW / 5.5 HP - 11 HP V = 20 cm/s  
18.5 kW- 37 kW/ 12.5 HP - 50 HP V = 50 cm/s

#### Optional

- Motors in complete 316
- PT 100 temperature sensor (sold separately)
- Motor with SiC-Shaft Seal
- Drop cable in different lengths up to 50m

#### Material AISI

Part	304 (Standard)	316
Shell	(SS AISI 304)	(SS AISI 316)
Endbell, Diaphragm cover	Cast Iron / powder coated	(SS AISI 316)
Housing thrust bearing	Cast Iron / powder coated	(SS AISI 316)
Seals	BUNA N	BUNA N
Seal Cover	(SS AISI 304)	(SS AISI 316)
Shaft Seal	SiC	SiC
Shaft end 4kW - 22kW / 5.5 HP - 30 HP	(SS AISI 420)	(SS AISI 316)
Shaft end 26kW-37kW/ 35 HP - 50 HP	(SS AISI 420)	(SS AISI 316)
Diaphragm	EPDM	EPDM
Lead	EPR	EPR

SUBMERSIBLE MOTORS			
Material	GG, Stainless Steel 304/316	Rating	3.7kW-37kW/5HP-50HP
Type	Rewindable MTSFC/ MTSFN	Thrust Rating	15500-27500

**6" Rewindable Motors - Model Numbers 50/60 Hz**

HP	kW	[V/Hz]	CONNECTION - Δ		
			CI	304	316
5.5	4	380/400/415 50Hz	9000006071	9000006263	9000006167
		415/460 60Hz			
7.5	5.5	380/400/415 50Hz	9000006072	9000006264	9000006168
		415/460 60Hz			
10	7.5	380/400/415 50Hz	9000006073	9000006265	9000006169
		415/460 60Hz			
12.5	9.3	380/400/415 50Hz	9000006074	9000006266	9000006170
		415/460 60Hz			
15	11	380/400/415 50Hz	9000006075	9000006267	9000006171
		415/460 60Hz			
17.5	13	380/400/415 50Hz	9000006076	9000006268	9000006172
		415/460 60Hz			
20	15	380/400/415 50Hz	9000006077	9000006269	9000006173
		415/460 60Hz			
25	18.5	380/400/415 50Hz	9000006078	9000006270	9000006174
		415/460 60Hz			
30	22	380/400/415 50Hz	9000006079	9000006271	9000006175
		415/460 60Hz			
35	26	380/400/415 50Hz	9000006080	9000006272	9000006176
		415/460 60Hz			
40	30	380/400/415 50Hz	9000006081	9000006273	9000006177
		415/460 60Hz			
50	37	380/400/415 50Hz	9000006082	9000006274	9000006178
		415/460 60Hz			

SUBMERSIBLE MOTORS			
Material	GG, Stainless Steel 304/316	Rating	3.7kW-37kW/5HP-50HP
Type	Rewindable MTSFC/ MTSFN	Thrust Rating	15500-27500

**6" Rewindable Motors - Model Numbers 50/60 Hz**

HP	kW	[V/Hz]	CONNECTION - YΔ		
			CI	304	316
5.5	4	380/400/415 50Hz	9000006083	9000006275	9000006179
		415/460 60Hz			
7.5	5.5	380/400/415 50Hz	9000006084	9000006276	9000006180
		415/460 60Hz			
10	7.5	380/400/415 50Hz	9000006085	9000006277	9000006181
		415/460 60Hz			
12.5	9.3	380/400/415 50Hz	9000006086	9000006278	9000006182
		415/460 60Hz			
15	11	380/400/415 50Hz	9000006087	9000006279	9000006183
		415/460 60Hz			
17.5	13	380/400/415 50Hz	9000006088	9000006280	9000006184
		415/460 60Hz			
20	15	380/400/415 50Hz	9000006089	9000006281	9000006185
		415/460 60Hz			
25	18.5	380/400/415 50Hz	9000006090	9000006282	9000006186
		415/460 60Hz			
30	22	380/400/415 50Hz	9000006091	9000006283	9000006187
		415/460 60Hz			
35	26	380/400/415 50Hz	9000006092	9000006284	9000006188
		415/460 60Hz			
40	30	380/400/415 50Hz	9000006093	9000006285	9000006189
		415/460 60Hz			
50	37	380/400/415 50Hz	9000006094	9000006286	9000006190
		415/460 60Hz			

SUBMERSIBLE MOTORS			
Material	GG, Stainless Steel 304/316	Rating	3.7kW-37kW/5HP-50HP
Type	Rewindable MTSFC/ MTSFN	Thrust Rating	15500-27500

**6" Rewindable Motors - Model Numbers 50/60 Hz**

HP	kW	[V/Hz]	CONNECTION - Δ		
			CI	304	316
5.5	4	230 60Hz	9000006119	9000006311	9000006215
7.5	5.5	230 60Hz	9000006120	9000006312	9000006216
10	7.5	230 60Hz	9000006121	9000006313	9000006217
12.5	9.3	230 60Hz	9000006122	9000006314	9000006218
15	11	230 60Hz	9000006123	9000006315	9000006219
17.5	13	230 60Hz	9000006124	9000006316	9000006220
20	15	230 60Hz	9000006125	9000006317	9000006221
25	18.5	230 60Hz	9000006126	9000006318	9000006222
30	22	230 60Hz	9000006127	9000006319	9000006223
35	26	230 60Hz	9000006128	9000006320	9000006224

SUBMERSIBLE MOTORS			
Material	GG, Stainless Steel 304/316	Rating	3.7kW-37kW/5HP-50HP
Type	Rewindable MTSFC/ MTSFN	Thrust Rating	15500-27500

**6" Rewindable Motors - Model Numbers 50/60 Hz**

HP	kW	[V/Hz]	CONNECTION - Y		
			CI	304	316
5.5	4	380 60Hz	9000006131	9000006323	9000006227
7.5	5.5	380 60Hz	9000006132	9000006324	9000006228
10	7.5	380 60Hz	9000006133	9000006325	9000006229
12.5	9.3	380 60Hz	9000006134	9000006326	9000006230
15	11	380 60Hz	9000006135	9000006327	9000006231
17.5	13	380 60Hz	9000006136	9000006328	9000006232
20	15	380 60Hz	9000006137	9000006329	9000006233
25	18.5	380 60Hz	9000006138	9000006330	9000006234
30	22	380 60Hz	9000006139	9000006331	9000006235
35	26	380 60Hz	9000006140	9000006332	9000006236
40	30	380 60Hz	9000006141	9000006333	9000006237
50	37	380 60Hz	9000006142	9000006334	9000006238

HP	kW	[V/Hz]	CONNECTION - YΔ		
			CI	304	316
5.5	4	230/380 60Hz	9000011937	9000012425	9000012430
7.5	5.5	230/380 60Hz	9000012179	9000012426	9000012432
10	7.5	230/380 60Hz	9000012015	9000012016	9000012433
12.5	9.3	230/380 60Hz	9000012178	9000012427	9000012434
15	11	230/380 60Hz	9000011606	9000011608	9000012436
17.5	13	230/380 60Hz	9000012176	9000012428	9000012437
20	15	230/380 60Hz	9000011028	9000011566	9000012439
25	18.5	230/380 60Hz	9000011029	9000011567	9000012440
30	22	230/380 60Hz	9000010939	9000011568	9000012442
35	26	230/380 60Hz	9000012177	9000012429	9000012443
40	30	230/380 60Hz	9000006129	9000011569	9000012445
50	37	230/380 60Hz	9000006130	9000011570	9000012445

SUBMERSIBLE MOTORS			
Material	GG, Stainless Steel 304/316	Rating	3.7kW-37kW/5HP-50HP
Type	Rewindable MTSFC/ MTSFN	Thrust Rating	15500-27500

### 6" Rewindable Motors Performance Data 50 Hz

[HP]	P <sub>N</sub> [kW]	Thrust F [N]	U <sub>N</sub> [V]	n <sub>N</sub> [min-1]	I <sub>N</sub> [A]	I <sub>A</sub> [A]	η(Eff.)[%] at % load			COS Φ ( PF) at % load			T <sub>N</sub> [Nm]	T <sub>A</sub> [Nm]
							50	75	100	50	75	100		
5	3.7	15500	380	2910	10.4	48	71	75	76	0.59	0.71	0.78	13.1	15.5
			400	2930	10.6	51	68	73	76	0.53	0.65	0.73	13.1	17.3
			415	2930	10.9	53	65	72	76	0.5	0.61	0.69	13	18.8
5.5	4	15500	380	2910	10.4	48	71	75	76	0.59	0.71	0.78	13.1	15.5
			400	2930	10.6	51	68	73	76	0.53	0.65	0.73	13.1	17.3
			415	2930	10.9	53	65	72	76	0.5	0.61	0.69	13	18.8
7.5	5.5	15500	380	2860	13.7	48	74	76	75	0.67	0.78	0.83	18.3	15.5
			400	2890	13.3	51	72	76	76	0.62	0.74	0.81	18.2	17.3
			415	2890	13.4	53	71	75	75	0.59	0.71	0.78	18.1	18.8
10	7.5	15500	380	2860	18.3	59	77	78	76	0.7	0.8	0.84	25	19.2
			400	2880	17.7	63	75	78	77	0.65	0.76	0.82	24.8	21.5
			415	2890	17.7	65	73	77	77	0.61	0.73	0.8	24.7	23.4
12.5	9.3	15500	380	2850	22	74	79	80	78	0.71	0.8	0.84	31.1	25.9
			400	2870	21.4	78	78	79	78	0.64	0.76	0.82	31	29
			415	2880	21.2	81	76	79	78	0.6	0.72	0.8	30.9	31.4
15	11	15500	380	2860	25.8	93	78	80	78	0.71	0.8	0.85	36.7	31.5
			400	2880	25.2	98	77	80	79	0.65	0.76	0.83	36.4	35.5
			415	2890	25.1	102	75	78	79	0.61	0.73	0.8	36.3	38.2
17.5	13	15500	380	2880	30.1	118	80	81	80	0.68	0.79	0.84	43.1	45
			400	2900	29.6	125	78	80	80	0.61	0.74	0.81	42.8	50.3
			415	2900	29.7	130	76	79	80	0.57	0.7	0.78	42.7	54.6
20	15	15500	380	2880	33.9	140	81	82	81	0.71	0.81	0.85	49.7	53.9
			400	2890	33.1	148	79	81	81	0.65	0.77	0.83	49.4	60.4
			415	2900	33	154	77	80	81	0.6	0.73	0.81	49.3	65.5
25	18.5	27500	380	2860	42.3	172	81	82	81	0.68	0.78	0.84	61.7	75.2
			400	2880	42	182	78	81	81	0.61	0.74	0.8	61.2	84.3
			415	2890	42.5	189	76	79	80	0.57	0.7	0.77	61.1	91.3
30	22	27500	380	2880	49.1	218	82	84	83	0.68	0.78	0.84	72.6	91.2
			400	2900	49	231	80	82	82	0.61	0.73	0.8	72.5	102.2
			415	2910	49.6	240	77	81	82	0.56	0.69	0.77	72.2	110.2
35	26	27500	380	2880	57.5	268	83	84	83	0.68	0.79	0.86	86	120.4
			400	2900	56.7	284	81	83	83	0.61	0.74	0.83	85.6	134.7
			415	2910	57.3	296	78	82	82	0.56	0.69	0.8	85.3	146.1
40	30	27500	380	2900	66.4	328	82	84	83	0.67	0.78	0.84	98.8	135
			400	2910	66.4	347	80	83	83	0.6	0.73	0.8	98.4	151
			415	2910	67.5	361	77	81	82	0.55	0.68	0.77	98.2	163
50	37	27500	380	2890	82	409	83	84	83	0.67	0.78	0.84	122.1	192.8
			400	2900	81.9	433	80	83	83	0.6	0.72	0.8	121.6	215.8
			415	2910	83.9	450	77	81	82	0.55	0.68	0.76	121.3	234

SUBMERSIBLE MOTORS			
Material	GG, Stainless Steel 304/316	Rating	3.7kW-37kW/5HP-50HP
Type	Rewindable MTSFC/ MTSFN	Thrust Rating	15500-27500

### 6" Rewindable Motors Performance Data 60 Hz

[HP]	P <sub>N</sub> [kW]	P <sub>max</sub> [kW]	Thrust F [N]	U <sub>N</sub> [V]	n <sub>N</sub> [min-1]	I <sub>N</sub> [A]	I <sub>A</sub> [A]	η(Eff.)[%] at % load			COS Φ ( PF) at % load			T <sub>N</sub> [Nm]	T <sub>A</sub> [Nm]
								50	75	100	50	75	100		
5.5	4	4.6	15500	460	3520	10.1	51	70	76	78	0.56	0.67	0.75	12.5	15.3
7.5	5.5	6.3	15500	460	3480	12.9	51	74	77	77	0.65	0.76	0.82	17.3	15.1
10	7.5	8.6	15500	460	3470	17.2	64	75	78	78	0.67	0.77	0.82	23.7	19.4
12.5	9.3	10.7	15500	460	3460	20.8	78	78	80	80	0.67	0.78	0.82	29.4	24.4
15	11	12.7	15500	460	3480	25	98	78	81	80	0.68	0.77	0.83	34.7	31.5
17.5	13	15	15500	460	3490	29	125	78	81	81	0.65	0.76	0.82	40.9	43.3
20	15	17.3	15500	460	3490	32.1	151	80	83	83	0.68	0.78	0.84	47.1	55.6
25	18.5	21.3	27500	460	3480	40.6	184	80	82	82	0.65	0.76	0.81	58.4	74.5
30	22	25.3	27500	460	3500	47.1	232	83	84	84	0.72	0.79	0.82	69.1	85.8
35	26	29.9	27500	460	3500	55.7	287	83	85	85	0.64	0.76	0.84	81.6	117.2
40	30	34.5	27500	460	3500	64.4	346	81	84	83	0.58	0.71	0.78	93.8	139.6
50	37	42.6	27500	460	3500	79.1	430	82	84	85	0.63	0.75	0.81	116	177.8

### Motor Lengths & Weights

P <sub>N</sub> [HP]	P <sub>N</sub> [kW]	L [mm] 304	L [mm] 316	Motor Weights [kg]	
				304/316	Incl. Packing
5	3.7	699	712	48	51
5.5	4	699	712	48	51
7.5	5.5	699	712	48	51
10	7.5	719	732	50	54
12.5	9.3	749	762	54	57
15	11	779	792	56	59
17.5	13	829	842	60	64
20	15	874	887	66	70
25	18.5	919	932	69	73
30	22	1009	1022	78	81.7
35	26	1114	1127	91	98
40	30	1214	1127	100	107
50	37	1294	1307	107	115

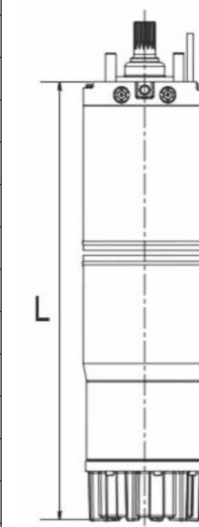

SUBMERSIBLE MOTORS			
Material	GG, Stainless Steel 304/316	Rating	3.7kW-37kW/5HP-50HP
Type	Rewindable MTSFC/ MTSFN	Thrust Rating	15500-27500

**6" Rewindable Motors Leads @ 400 V**

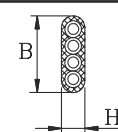
DOL	[kW]	[HP]	St.	Ø	B/H	Length
			#	[mm <sup>2</sup> ]	[mm]	[M]
	3.7-13	5-7.5	1	4X2.5	19X7	4
	15-22	20-30	1	4X4	23X8.2	4
	26-37	35-40	1	4X6	25X9	4

Ground Lead (option)	[kW]	[HP]	St.	Ø	B/H	Length
			#	[mm <sup>2</sup> ]	[mm]	[M]
	37	50	1	10	D=11.5	4

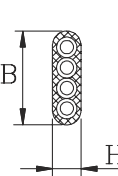
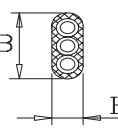
YΔ	[kW]	[HP]	St.	Ø	B/H	Length
			#	[mm <sup>2</sup> ]	[mm]	[M]
	3.7 - 22	5 - 30	1	3 X 2.5	15.3X7.3	4
			1	4 X 2.5	19X7	4
	26 - 37	35 - 50	1	3 X 4	17.8X8.5	4
			1	4X 4	23X8.2	4

SUBMERSIBLE MOTORS			
Material	GG, Stainless Steel 304/316	Rating	3.7kW-37kW/5HP-50HP
Type	Rewindable MTSFC/ MTSFN	Thrust Rating	15500-27500

**6" Rewindable Motors Performance Data 50Hz**

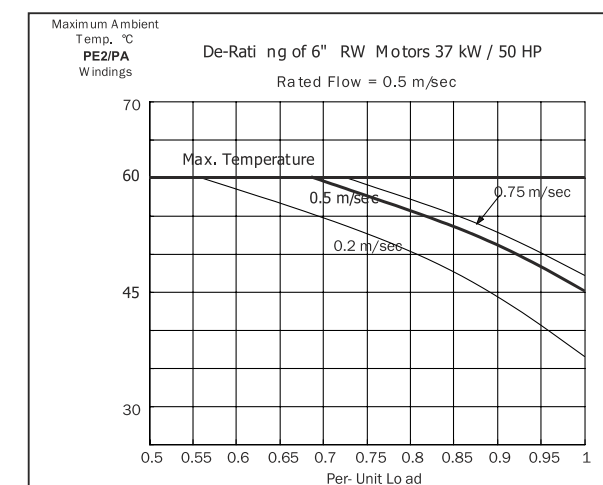
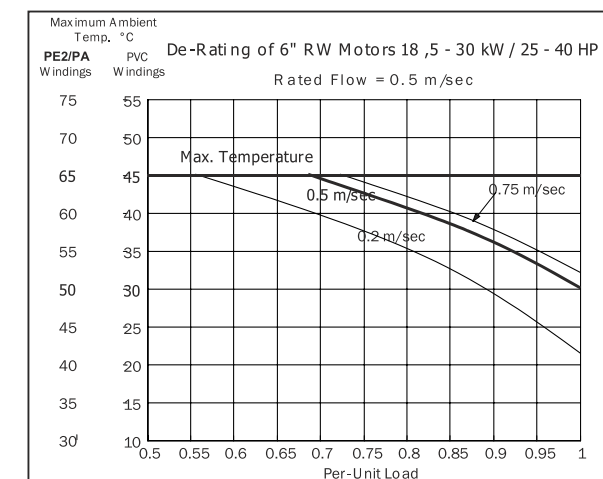
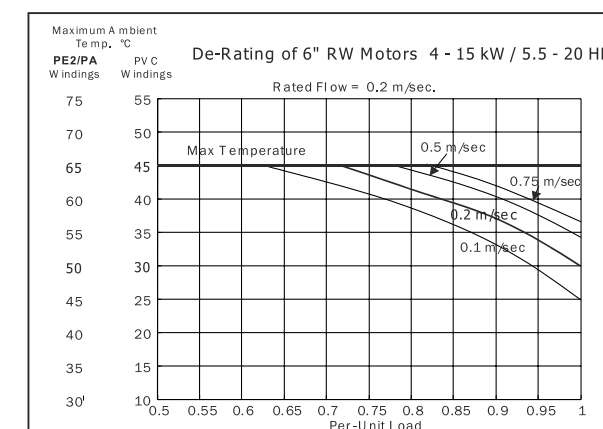

Above conditions are not met please contact Shakti Pumps

### SUBMERSIBLE MOTORS

Material	GG, Stainless Steel 304/316	Rating	3.7kW-37kW/5HP-50HP
Type	Rewindable MTSFC/ MTSFN	Thrust Rating	15500-27500

#### Exploded View

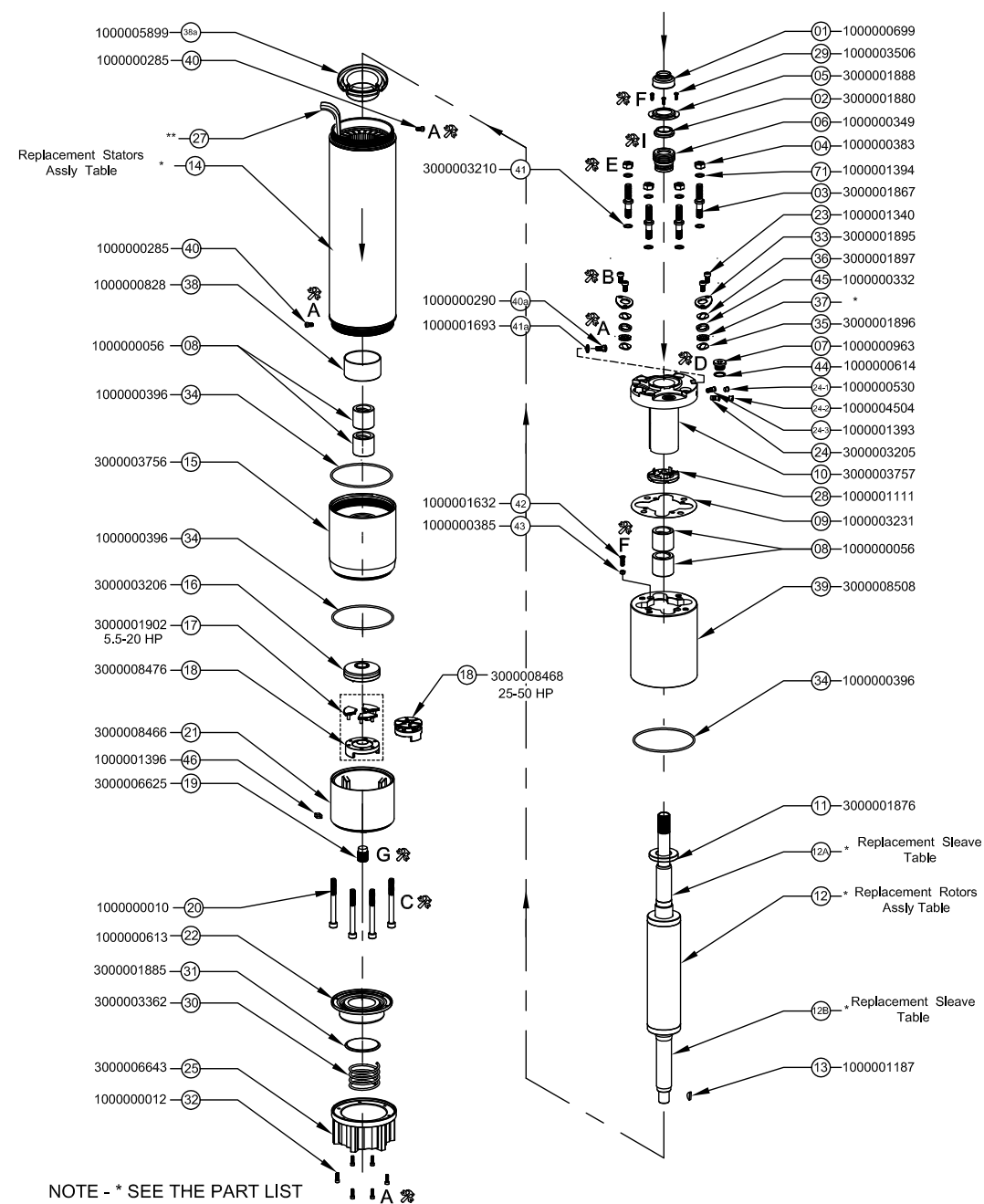

#### TOOLS



### SUBMERSIBLE MOTORS

Material	GG, Stainless Steel 304/316	Rating	3.7kW-37kW/5HP-50HP
Type	Rewindable MTSFC/ MTSFN	Thrust Rating	15500-27500

#### 6" Rewindable Motors Leads @ 400 V

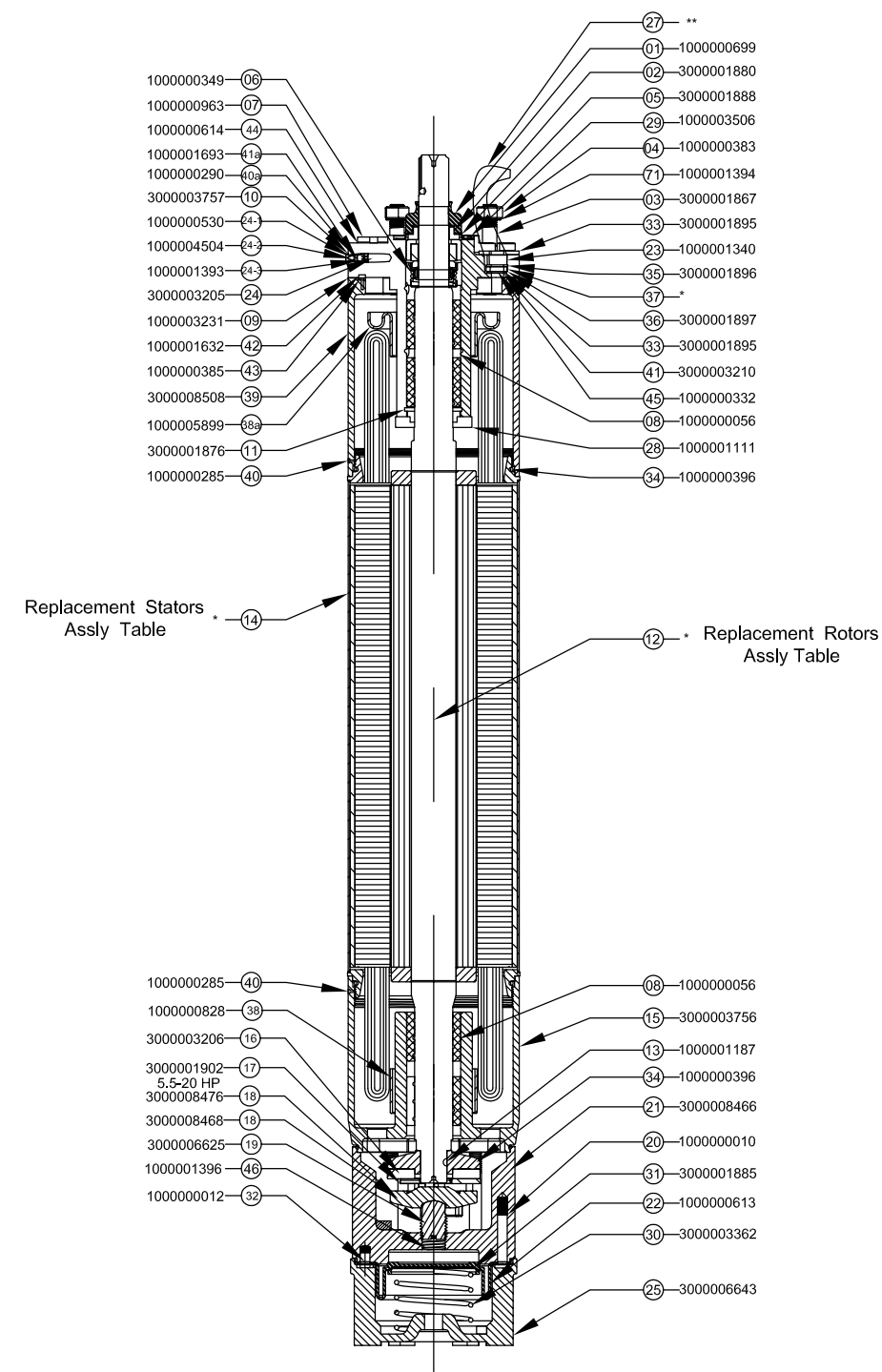



SUBMERSIBLE MOTORS			
Material	GG, Stainless Steel 304/316	Rating	3.7kW-37kW/5HP-50HP
Type	Rewindable MTSFC/ MTSFN	Thrust Rating	15500-27500

POS	MATERIAL CODE	PART DISCRIPTION	QTY	MATERIAL
1	1000000699	SAND SLINGER	1	NEOPRINE RUBBER
29	1000003506	SLOTED THRCUTSCREW(M4)	3	SS AISI-304
5	3000001888	DUST COVER	1	SS AISI-304
2	3000001880	BUSH	1	LTB-4
6	1000000349	MECH SEAL ASSLY	1	N/A
4	1000000383	NUT M12(HH)	4	SS AISI-304
71	1000001394	SPRING WASHER	4	SS AISI-304
3	3000001867	STUD(M12)	4	SS AISI-304
41	3000003210	GASKET WASHER	4	CAF GASKET
23	1000001340	ALLEN BOLT M8X12	4	SS AISI-304
33	3000001895	LEAD CLAMP	2	SS AISI-304
36	3000001897	LEAD SEAL UPPER	2	SS AISI-304
45	1000000332	LEAD SPACER	2	HDPE
37	1000000278	GROMATE 4/6Sq.mm 3 CORE FLATE	2	NITRILE RUBBER
	1000000270	GROMATE 10 Sq.mm 3 CORE FLATE		
	1000000276	GROMATE 2.5 Sq.mm 3 CORE FLATE		
	1000000272	GROMATE 16 Sq.mm 3 CORE FLATE		
35	3000001896	LEAD SEAL LOWER	2	SS AISI-304
7	1000000963	DRAIN PLUG	1	BRASS
44	1000000614	RUBBER GASKET WASHER	1	NBR
24-1	1000000530	PVC CAP(WHITE)	1	PP
24-2	1000004504	PVC CAP(GREEN)	1	PP
24-3	1000001393	FILTER	2	N/A
24	3000003205	PRESSUR RELIEF VALUE ASSLY.	2	N/A
10	3000003757	END BELL UPPER	1	CI FG-260
28	1000001111	UP THRUST BEARING	1	NORYL(GLASS FILLED)
9	1000003231	GASKET	1	OILPAPER
8	1000000056	BUSH CARBON	2	REGIN IMPREGATED CARBON
39	3000008508	WINDING COVER	1	CI FG-260
34	1000000396	O-RING(123.5X3.5)	1	EPDM
40a	1000000290	H.H. BOLT M6X12 mm	1	SS AISI-304
41a	1000001693	S.S WASHER M6XTH.1.0mm	1	SS AISI-304
42	1000001632	CHEESE HEAD SCREW	1	SS AISI-304
43	1000000385	NUT(M6)	1	SS AISI-304
11	3000001876	THRUST PLATE	1	CI FG-260
12	*	ROTOR SUB ASSLY	1	N/A
13	1000001187	WOODRUF KEY(5X7.5)	1	En8
38a	1000005899	UPPER SUPPORT RING	1	PPS
40	1000000285	GRUB SCR(W)M5X6)	1	BRASS
27	**	CABLE	1	RUBBER
14	*	STATOR SUB ASSLY	1	N/A

SUBMERSIBLE MOTORS			
Material	GG, Stainless Steel 304/316	Rating	3.7kW-37kW/5HP-50HP
Type	Rewindable MTSFC/ MTSFN	Thrust Rating	15500-27500

POS	MATERIAL CODE	PART DISCRIPTION	QTY	MATERIAL
40	1000000285	GRUB SCR(W)M5X6)	1	BRASS
38	1000000828	SUPPORT RING	1	PPS
8	1000000056	BUSH CARBON	2	REGIN IMPREGATED CARBON
34	1000000396	O-RING(123.5X3.5)	1	EPDM
15	3000003756	END BELL LOWER	1	CI FG-260
34	1000000396	O-RING(123.5X3.5)	1	EPDM
16	3000003206	REVOLVING PLATE ASSLY	1	N/A
17	3000001902	THUST BRG.SEG	3	AISI SS-420
18	3000008476	THRUST BER PLATE(5-20 HP)	1	CI FG-260
18	3000008468	THRUST BER PLATE(25-50 HP)	1	CI FG-260
21	3000008466	THRUST BEARING HOUSING	1	CI FG-260
46	1000001396	MAGNET	1	MAGNET
19	3000006625	ADJUSTING STUD	1	DUPLEX
20	1000000010	ALLEN BOLT M10X100	4	SS AISI-304
22	1000000613	DIAPHRAM	1	EPDM
31	3000001885	DIAPHRGAM PLATE	1	SS AISI-304
25	3000006643	MOTOR BASE	1	CI FG-260
32	1000000012	ALLEN BOLT M5X16	6	SS AISI-304

SUBMERSIBLE MOTORS			
Material	GG, Stainless Steel 304/316	Rating	3.7kW-37kW/5HP-50HP
Type	Rewindable MTSFC/ MTSFN	Thrust Rating	15500-27500

**Replacement Rotors Assly**

POS	P <sub>N</sub>	P <sub>N</sub>	ROTOR	ROTOR MODEL NO. (CI)/(304)	ROTOR MODEL NO. (316)
	[HP]	[kW]			
12.01	5.50	4.00	ROTOR ASSLY CL-180	3000002166	3000002177
12.02	7.50	5.50	ROTOR ASSLY CL-180	3000002166	3000002177
12.03	10.00	7.50	ROTOR ASSLY CL-200	3000002167	3000002178
12.04	12.50	9.30	ROTOR ASSLY CL-230	3000002168	3000002179
12.05	15.00	11.00	ROTOR ASSLY CL-260	3000002169	3000002180
12.06	17.50	13.00	ROTOR ASSLY CL-310	3000002170	3000002181
12.07	20.00	15.00	ROTOR ASSLY CL-355	3000002171	3000002182
12.08	25.00	18.50	ROTOR ASSLY CL-400	3000002172	3000002183
12.09	30.00	22.00	ROTOR ASSLY CL-490	3000002173	3000002184
12.10	35.00	26.00	ROTOR ASSLY CL-595	3000002174	3000002185
12.11	40.00	30.00	ROTOR ASSLY CL-695	3000002175	3000002186
12.12	50.00	37.00	ROTOR ASSLY CL-775	3000002176	3000002187

**Replacement Sleeve**

POS	P <sub>N</sub>	P <sub>N</sub>	UPPER SLEEVE	LOWER SLEEVE	ROTOR MODEL NO.
	[HP]	[kW]			
12A.01	5.50	4.00	LENGTH -115.0mm 3000001866	LENGTH - 131.5mm 3000022409	3000002166
12A.02	7.50	5.50			3000002166
12A.03	10.00	7.50			3000002167
12A.04	12.50	9.30			3000002168
12A.05	15.00	11.00			3000002169
12A.06	17.50	13.00			3000002170
12A.07	20.00	15.00	LENGTH -115.0mm 3000001866	LENGTH - 119.0mm 3000022410	3000002171
12B.01	25.00	18.50			3000002172
12B.02	30.00	22.00			3000002173
12B.03	35.00	26.00			3000002174
12B.04	40.00	30.00			3000002175
12B.05	50.00	37.00			3000002176

SUBMERSIBLE MOTORS			
Material	GG, Stainless Steel 304/316	Rating	3.7kW-37kW/5HP-50HP
Type	Rewindable MTSFC/ MTSFN	Thrust Rating	15500-27500

**Replacement Stators Assly**

POS	P <sub>N</sub>	P <sub>N</sub>	STATORS	ROTOR MODEL NO. (CI)/(304)	ROTOR MODEL NO. (316)
	[HP]	[kW]			
14.01	5.50	4.00	STATOR ASSLY	3000002223	3000002212
14.02	7.50	5.50	STATOR ASSLY	3000002223	3000002212
14.03	10.00	7.50	STATOR ASSLY	3000003158	3000002213
14.04	12.50	9.30	STATOR ASSLY	3000002224	3000002214
14.05	15.00	11.00	STATOR ASSLY	3000002225	3000002215
14.06	17.50	13.00	STATOR ASSLY	3000002226	3000002216
14.07	20.00	15.00	STATOR ASSLY	3000002227	3000002217
14.08	25.00	18.50	STATOR ASSLY	3000002228	3000002218
14.09	30.00	22.00	STATOR ASSLY	3000002229	3000002219
14.10	35.00	26.00	STATOR ASSLY	3000002230	3000002220
14.11	40.00	30.00	STATOR ASSLY	3000002231	3000002221
14.12	50.00	37.00	STATOR ASSLY	3000002232	3000002222

SUBMERSIBLE MOTORS			
Material	GG, Stainless Steel 304/316	Rating	3.7kW-37kW/5HP-50HP
Type	Rewindable MTSFC/ MTSFN	Thrust Rating	15500-27500

[kW]	[HP]	[V]/Hz	Stator incl. Winding		ROTOR
			DOL	YΔ	
30	40	380, 400, 415/50, 460/60	300003160	300003161	300002188
37	50	380, 400, 415/50, 460/60	300003811	300008280	300002188
45	60	380, 400, 415/50, 460/60	300003812	300003813	300002189
52	70	380, 400, 415/50, 460/60	300008283	300008284	300002190
55	75	380, 400, 415/50, 460/60	300003814	300003815	300002190
60	80	380, 400, 415/50, 460/60	300008281	300008282	300002191
67	85	380, 400, 415/50, 460/60	300008279	300004057	300002191
75	100	380, 400, 415/50, 460/60	300003816	300003817	300002192
83	110	380, 400, 415/50, 460/60	300004054	300004055	300002193
93	125	380, 400, 415/50, 460/60	300003162	300003818	300002193

**Standard Windings (380 – 415 / 460 Volt and 50 / 60 Hz)**

[HP]	[kW]	Mod.-No. Winding kits	Turns per coil	Wire diameter No. of wire	Type of Isolation	Group connection	Total Wire length [m]	Resistant coil [Ω]	Resistant YΔ (U1-U2) [Ω]	Resistant Dol (U1-V1) [Ω]
40	30	326 349 999	9+10+9+10	3.1 x 1	PVC	Series	450.00	0.41	0.8200	0.30
50	37	326 101 999	17+17+17+17	2.4 x 1	PVC	Parallel	630.00	0.45	0.9000	0.38
60	45	326 110 999	14+14+14+14	2.6 x 1	PVC	Parallel	582.48	0.30	0.1500	0.25
70	52	326 120 999	12+12+12+12	2.8 x 1	PVC	Parallel	655.00	0.32	0.1700	0.21
75	55	326 119 999	11+12+11+12	2.0 x 2	PVC	Parallel	542.40	0.29	0.1540	0.19
80	60	326 129 999	10+10+10+10	2.2 x 2	PVC	Parallel	536.40	0.24	0.1280	0.20
85	67	326 128 999	9+10+9+10	2.2 x 2	PVC	Parallel	510.48	0.19	0.1100	0.14
100	75	326 135 999	8+9+8+9	2.4 x 2	PVC	Parallel	990.72	0.18	0.0957	0.14
110	83	326 142 999	7+8+7+8	2.5 x 2	PVC	Parallel	1008.00	0.16	0.0851	0.11
125	93	326 141 999	7+7+7+7	2.6 x 2	PVC	Parallel	943.20	0.70	0.0851	0.11

**Spare parts : Other**

Pictured Repair instruction	Mod.- No.:	MTSFC200
Filling liquid 20 l / -15°C	Mod.- No.:	03520009

**Insulation Resistance (20°C/500 VDC)**

New motor without drop cable	200 > MΩ
Used motor without drop cable	20 > MΩ
New motor with drop cable	2 > MΩ
Used motor with drop cable	0.5 -2 MΩ

SUBMERSIBLE MOTORS			
Material	GG, Stainless Steel 304/316	Rating	3.7kW-37kW/5HP-50HP
Type	Rewindable MTSFC/ MTSFN	Thrust Rating	15500-27500

**Outline drawings**

